

Intro to
Microsoft
Windows



JEFFERSON COUNTY
LIBRARY
DISTRICT

Course Schedule

Dates and Titles	Times
March 22 – Internet Basics	Fridays,
March 29 – Microsoft Office 365	2:00 – 3:30 pm
April 5 – Email Basics	
April 12 – File Management	
April 19 – Staying Safe Online	
April 26 - Settings	

Tech Tuesdays

- **April 2** - Your Google Account
- **April 9** – Your Microsoft Account
- Time: 3:00 – 4:30 pm
- Description: Learn how to sign-up for Microsoft and Google accounts and the services included.

Objectives

- Learn the Microsoft Windows interface.
- Find and open programs.
- Manage windows.
- Connect to WiFi.

Vocabulary

- Desktop
- Taskbar
- Start Menu
- Search Bar
- WiFi

Operating Systems

To begin, what is an operating system?

An operating system is software that manages computer hardware and software resources.

It acts as an interface between the user and the computer hardware.

Operating Systems

- Microsoft Windows
- MacOS
- IOS
- Android

Quiz

What is an operating system?

- A. Your primary physician
- B. A television
- C. Software that manages computer hardware and software resources.

Microsoft Windows

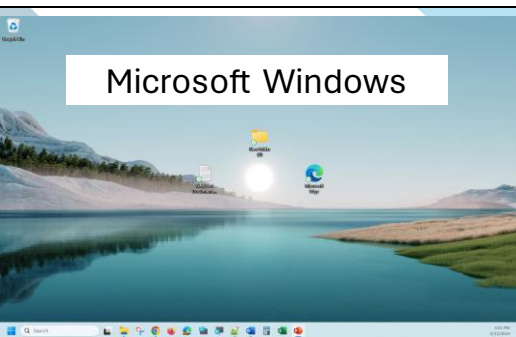

Desktop

The desktop is a place you keep frequently used applications, files, and folders.

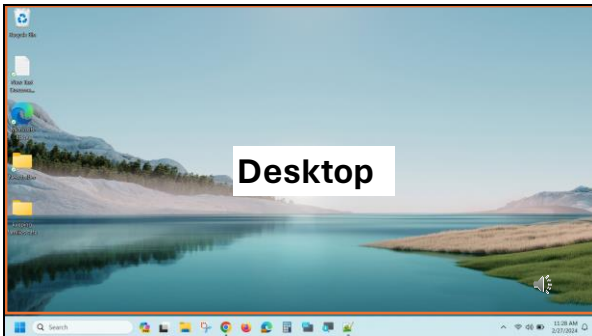

Taskbar

The taskbar is a place to keep programs you use often and see what programs are currently open.



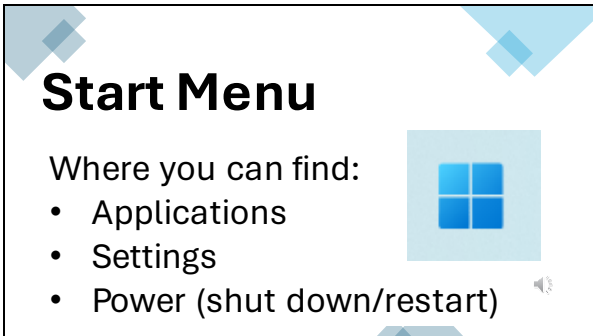

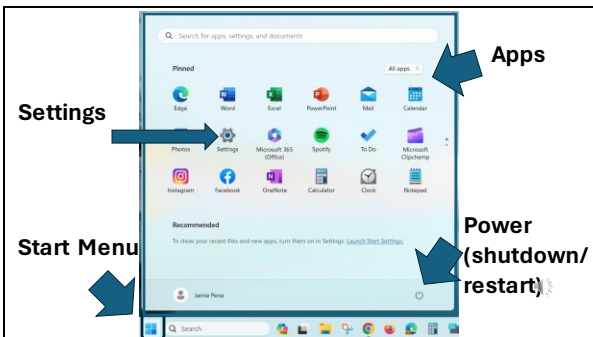

Search

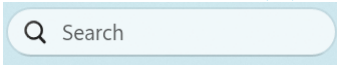

Look for applications, files, and folders on your computer.



Search

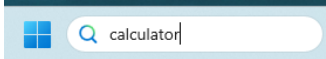

Type 'calculator'.



Search

Click the icon or 'open'.

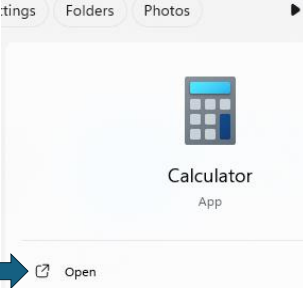

Quiz

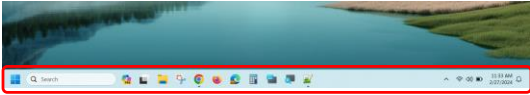

What is this area called?

What is this space called?

Quiz

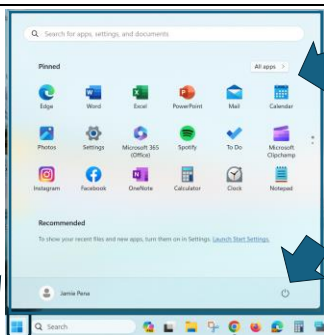

What are the 3 arrows pointing to?

Quiz

What are 2 places you can find and open applications in Microsoft Windows?

- A. Desktop
- B. Taskbar
- C. Power button
- D. Start Menu
- E. Search Bar
- F. WiFi

Connecting to WiFi

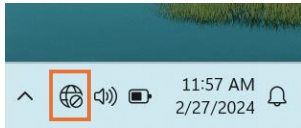

The globe means you are not connected.
Click on it to see available connections.

Connect to WiFi

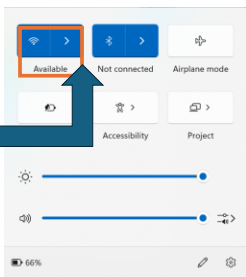

Click the ">" to see available networks.

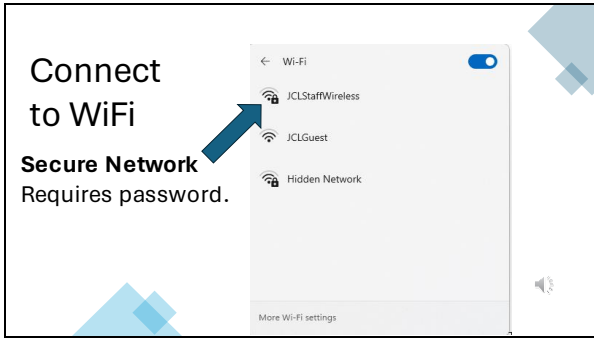

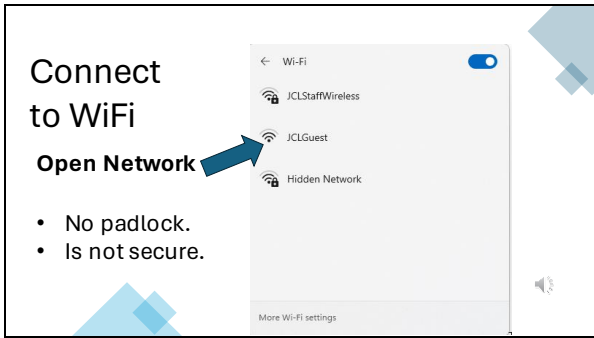

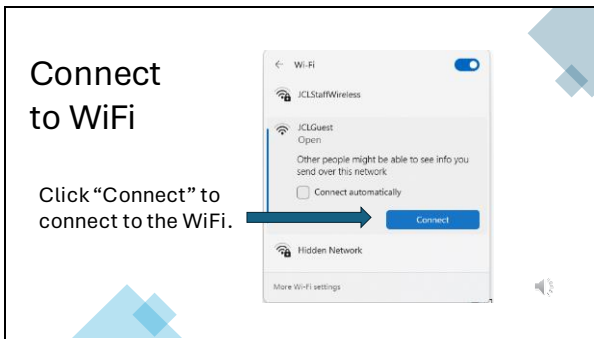

Quiz

Which icon should I click to connect to WiFi?



Managing Windows

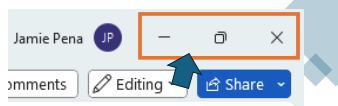

All windows can be managed in the upper-right hand corner.

Using what you've learned open Microsoft Word.

Minimizing Windows

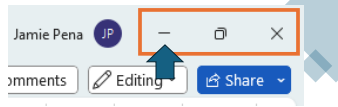

“-” leaves the program open but puts it on the taskbar.

Minimize the Word document.

Restore a minimized window



A minimized window will appear on the taskbar with “.” beneath it.

Hover over it to see a preview.

Click on the Word document to restore it.

Make a program full screen



Clicking on the square makes a window “full screen”.

Click on the square to make the Word document fill the screen.

Restore Down



If your window is already “full screen” you will see two squares.

This is called **restore down**. This will reduce the window’s size.

Click on the **restore down** button.

Close

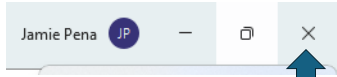

Click on the X to close the Microsoft Word document.

If prompted, choose "do not save."

Quiz

Which button closes a window?



Quiz

Which button makes a window full screen?



Quiz

Which button minimizes a window?



Quiz

Bonus: Where do minimized programs go?

- Desktop
- Taskbar
- Start Menu
- WiFi



Creating Shortcuts

You can add applications to the taskbar so they are easier to find.

You can add them through the Start Menu and the Search Bar.



From the Start Menu

Click on the Start Menu.



Right-click on Microsoft Word.

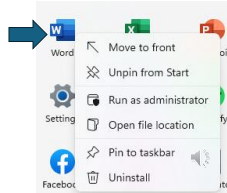

Right-click = press one time on the right side of the mouse.

Right-click opens menus.

From the Start Menu

Left-click on **Pin to Taskbar**.

Look at the taskbar.

A shortcut for Microsoft Word has now been added to the taskbar.

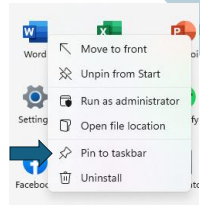

Taskbar Shortcut



From the Search Bar

Using the Search Bar, enter Excel or another program on your computer.

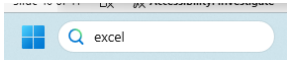

From the Search Bar

Click (left-click) on
"Pin to Taskbar".



- Open
- Run as administrator
- Open file location
- Unpin from Start
- Pin to taskbar**
- Uninstall



Excel
App

From the Search Bar



Shutting Down

This is the power symbol.

You will find it in the **Start Menu**.

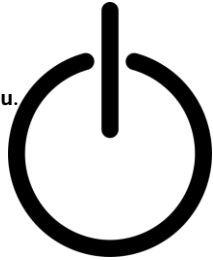

Shutting Down

Click on the Power symbol and select "Shut Down."

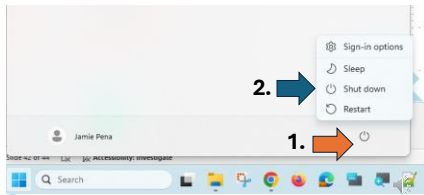

Quiz

Which button do you use to shut down a computer?